

EXISTING NETWORK

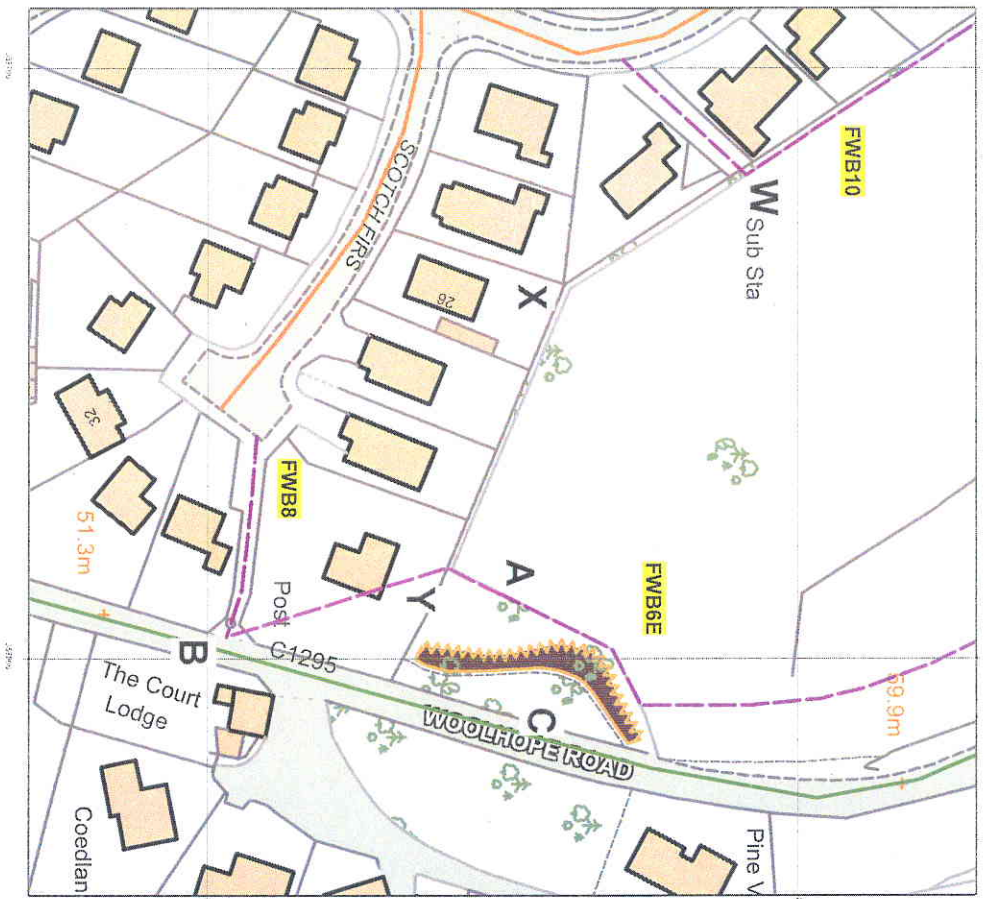

PROPOSED NETWORK

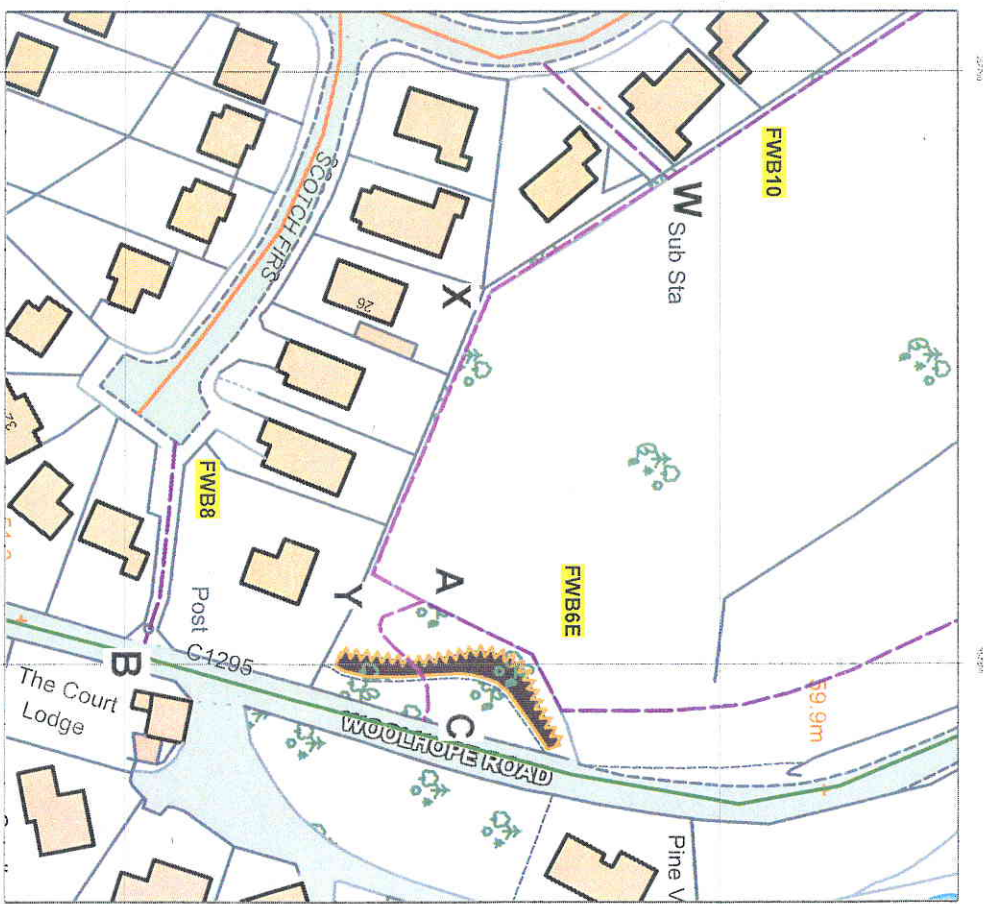

- PUBLIC FOOTPATH
- PUBLIC BRIDLEWAY
- RESTRICTED BYWAY
- BYWAY OPEN TO ALL TRAFFIC

NORTH

LOCATION PLAN - DIVERSION OF FOOTPATH FWB6E
& DEDICATION OF CONNECTING FOOTPATH

SCALE 1:1250

Dwg: Dedication / 1498 - 6E



Reproduced from Ordnance Survey mapping with the permission of the Controller of Her Majesty's Stationery Office. Crown Copyright. Unauthorised reproduction infringes Crown copyright and may lead to prosecution or civil proceedings. 100024168, 2010. This information is based on that currently available to the County of Herefordshire District Council from the definitive map and statement and other public records. It is given on the strict understanding that neither the Council nor any of its officers will be responsible for the accuracy or the information or should any liability whatsoever for any error or omission thereon for any loss or damage arising from interpretation or use of the information supplied. The inquirer should rely on the results of their own investigations.

Amey Herefordshire
Unit 3, Thorn Business Park
Rotherwas Industrial Estate
Hereford HR2 6JT
Tel.: (01432) 845900
Email: ameyherefordshire@amey.co.uk